

Controller Instructions

⚠ BEFORE YOU START

Read these instructions carefully. For the latest instructions on all our products see www.rclighting.com/instructions

⚠ **WARNING** Product contains a Class II laser. Do not stare into beam.

Controller Overview

- ① OLED Display
- ② Global Command
- ③ Pan Left
- ④ Select (Activate Laser)
- ⑤ Dim Up
- ⑥ Dim Down
- ⑦ Lamp On/Off
- ⑧ Tilt Up
- ⑨ Pan Right
- ⑩ Tilt Down
- ⑪ Function Up
- ⑫ Confirm/Send
- ⑬ Function Down
- ⑭ Back
- ⑮ Laser
- ⑯ Infrared Diode

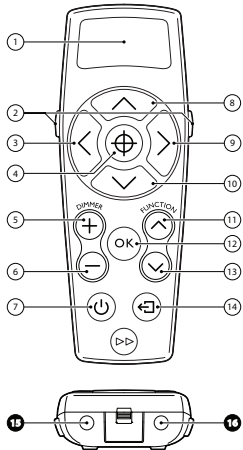

i Before You Start

This remote requires three AAA batteries. To replace batteries, push down and slide off cover.

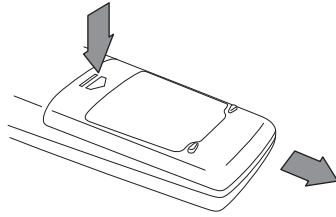

Ensure batteries are properly oriented in the battery compartment. When disposing of these batteries, please do so according to local regulations.

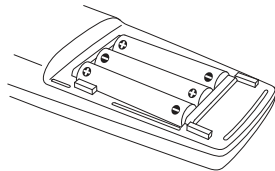

Please note, light shown in these instructions is a DR2, these instructions apply to all RCL lights.

If you have any difficulty operating this product please contact:

Remote Controlled Lighting Ltd (UK)
 42 Riverside Road, London SW17 0BA
 +44 (0) 20 8404 2400
 tech@rclighting.com

Remote Controlled Lighting Ltd (Asia)
 T1, 5/F Hi Yip Factory Building
 2 Hi Yip Street, Hong Kong
 +852 2310 9733

A Basic Operation

Spotlights are selected using the handheld remote and can then be controlled in *pan*, *tilt* and *dim* level. When using the remote, keep it aimed at the spotlight to ensure control signals are received. For best results, stand directly under the spotlight when aiming the remote.

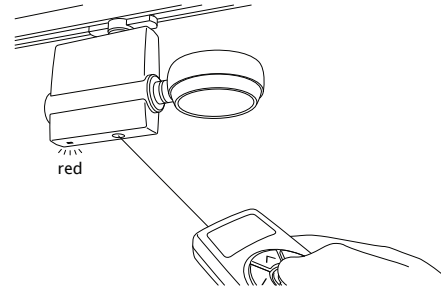

- 1 Switch on laser using button and aim beam at spotlight sensor. LED on spotlight will illuminate **red** to show the light has been selected.

NOTES

- When *Select* button is held, LED on spotlight will flash to help you aim the laser (newer models only).

- 2 Rotate spotlight in pan using buttons. Use buttons to rotate spotlight in tilt.
- 3 Adjust the brightness using buttons.

- 4 Use button to turn toggle lamp on and off.

NOTES

- Fittings using Metal Halide lamps cannot be dimmed but certain models can be switched on/off.
- Dim level is shown as a percentage on the controller display.

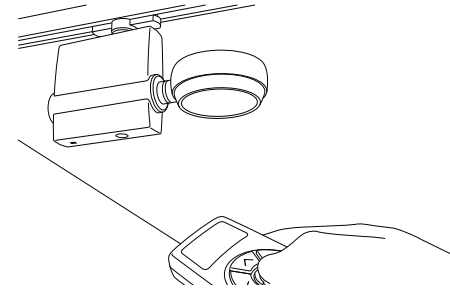

- 5 To deselect, aim controller approximately 1m AWAY from spotlight sensor and press button. LED on spotlight will turn off to show light has been deselected.

B Record a Scene

It's possible to record scenes using your handheld remote that can then be recalled easily using the *Function Menu*.

- 1 Select a spotlight using and set the desired position and brightness, as shown in Section A.

- Cycle through *Function Menu* using buttons and select *Record Scene* using button.
- Use buttons to choose which scene to record.
- Aim controller at spotlight and press button. The **red** LED on the light will flash to show the scene has been recorded.
- To go back to the previous menu at any time, press button.
- Deselect spotlight using button.

NOTES

- The spotlight may return to its *home* position briefly once the command has been received.
- The controller display will time out after 15 seconds if no button is pressed.

C Recall a Scene

- Select spotlight using .
- Choose *Recall Scene* from the *Function Menu* using buttons and press to select.
- Select the desired prerecorded scene using the buttons.
- Aim controller at spotlight and press button to recall the scene.
- Press button to deselect spotlight.

D Global Record

The global command buttons allow you to record and recall preset positions for a group of lights without the need to select each one first with the laser pointer.

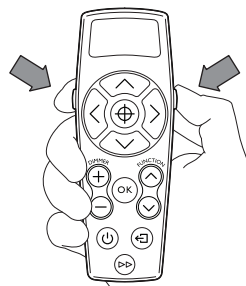

- Select a spotlight in the group using and set the desired position and brightness, as shown in Section A (overleaf).
- Deselect the light and repeat **Step 1** for each spotlight in the group.
- Use buttons to select *Record Scene* from the *Function Menu* and press to confirm.
- Choose the desired scene using the buttons.
- Aiming the controller at the first light in the group, hold BOTH global buttons and press the button. The LED on the spotlight will illuminate **green** to show the signal has been received.

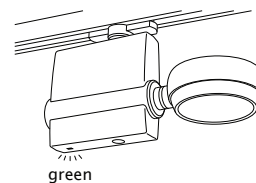

- Repeat Step 5 for each spotlight in the group until all the LEDs have illuminated **green**.
- To exit *Record Scene* mode, press button twice or wait for screen to time out.

NOTES

- When global commands have been received, the spotlight's LED will illuminate *green* for 15 seconds.
- When global buttons are pressed, *Global Mode* will display on the controller's screen.

E Global Recall

- Choose *Recall Scene* from the *Function Menu* using buttons and press to select.
- Select a previously recorded scene position using the buttons.

- Aiming the controller at the first light in the group, hold BOTH global buttons and press the button. The LED on the spotlight will illuminate **green** to show the signal has been received and the spotlight will adjust to its prerecorded position and brightness.
- Repeat **Step 3** for each spotlight in the group until all the LEDs have illuminated **green**.
- To exit *Recall Scene* mode, press button twice or wait for screen to time out.

F Global Brightness

The global command buttons can be used to set all the lights in a group to the same brightness without selecting them individually first.

- Use buttons to select the desired brightness level on the controller's screen.
- Whilst holding BOTH global buttons, press the button and aim the controller at each light in the group. The LED on the spotlight will illuminate **green** to show the signal has been received.
- The lights in a group can be switched on or off using the button and repeating **Step 2**.